

### 2.1) Ground Floor:

The ground floor of our model will serve as an animal husbandry area, where cows would be reared. They would be reared by specialized employees. Their milk would be merchandized. The waste would be sent to bio gas plant for energy production.

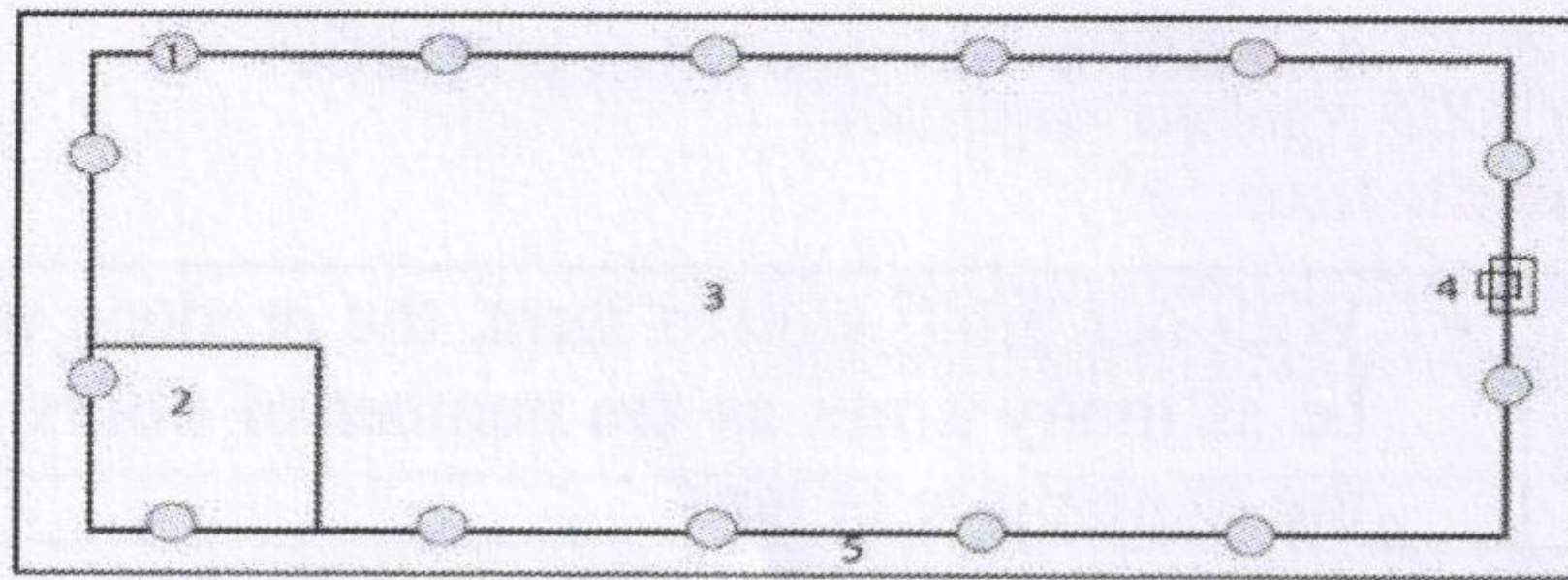

Figure 2: Ground Floor

### 2.2) 1<sup>st</sup> Floor:

The first floor will serve as a health improvement centre. Research asserts that increased level of oxygen in the environment leads to faster recovery from illness. An environment which makes the proposition formerly mentioned possible can be achieved with the help of mosses (which are known for their relatively higher rate of converting deoxygenated air into oxygenated air and will act as sidewalls in our model) and neem trees. People traumatized can also come here for a natural therapy session.

The trees would adapt themselves in order to not be oversized for the space. The natural adaption would be extensively supplemented with controlled growth

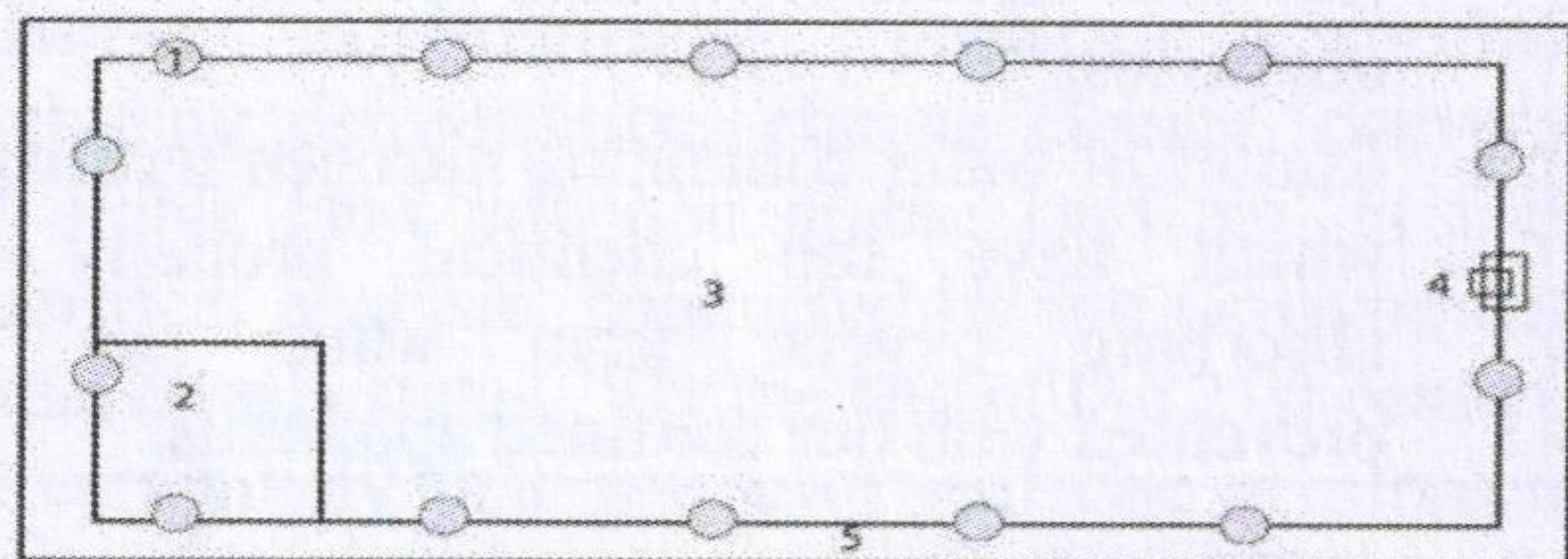

Figure 3: First Floor

### 2.3) 2<sup>nd</sup> Floor:

The second floor primarily serves as a library. Apart from a substantial increase in concentration level, the setting offers a rare experience: a library amidst a bamboo forest.

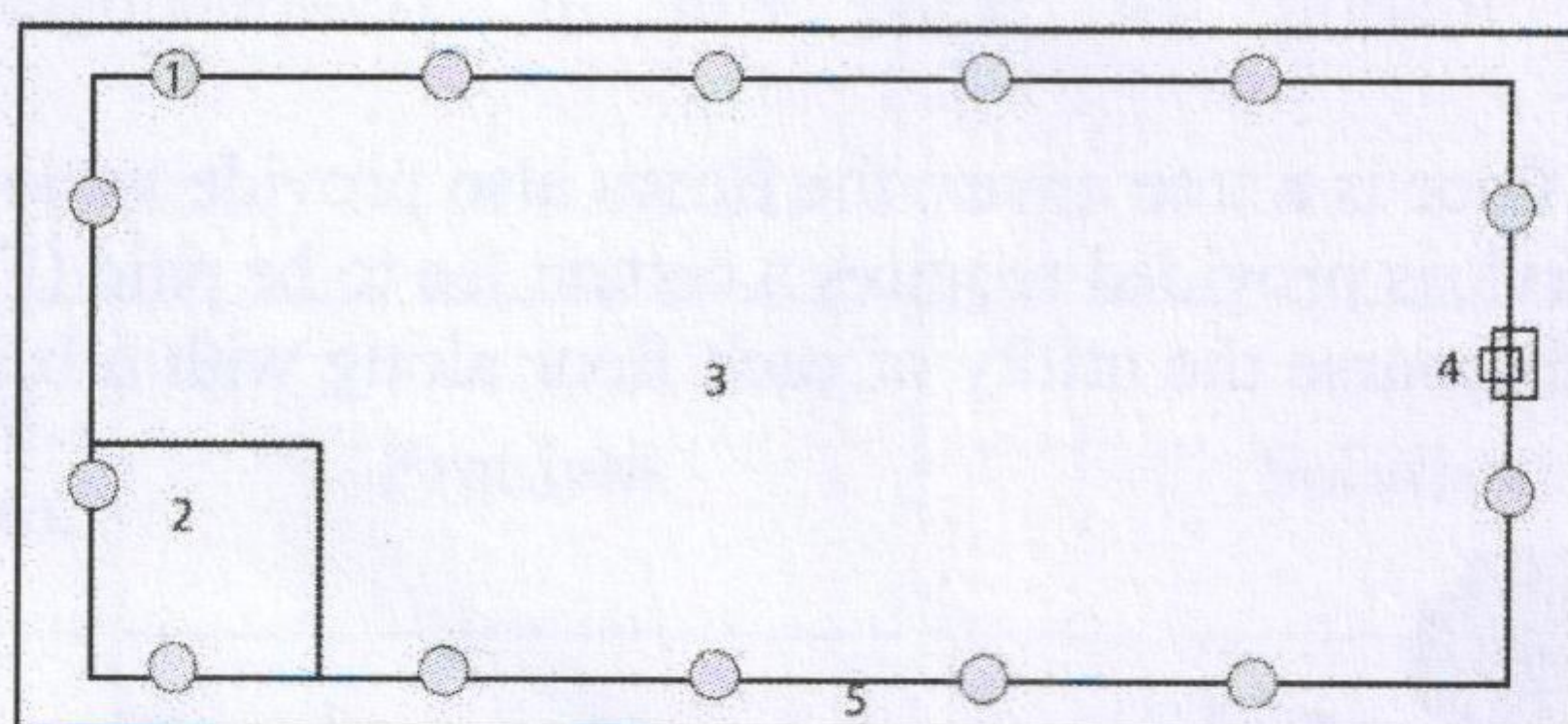

Figure 4: Second Floor

### 2.4) 3<sup>rd</sup> Floor:

The third floor serves as a playground. The vegetation on this floor – Senna – is carefully chosen to meet the setting. The plant possesses commercial significance as well as an appealing structure.

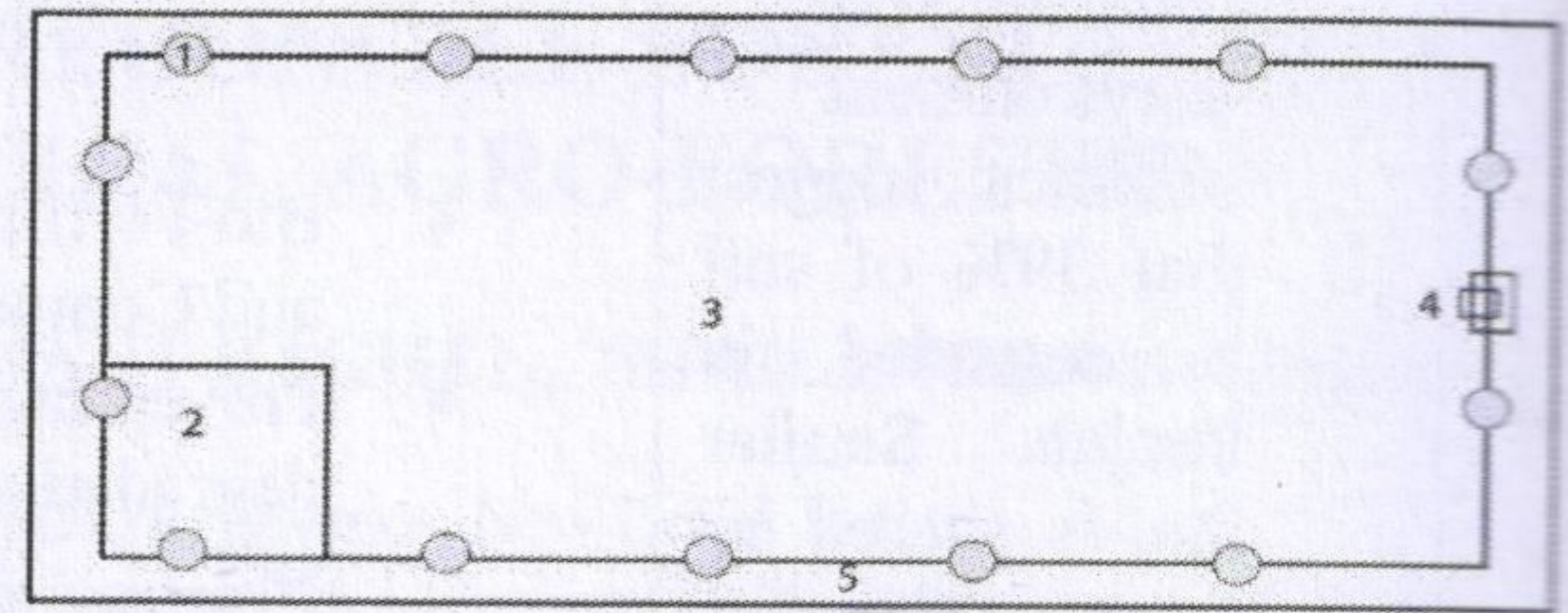

Figure 5: Third Floor

### 2.5) 4<sup>th</sup> Floor:

The top floor would be the marrow of the model. It is a full fledging forest. Babool and Guava would be the primary vegetation on the floor. The floor also features solar trees which provide the model a major part of the energy it requires.

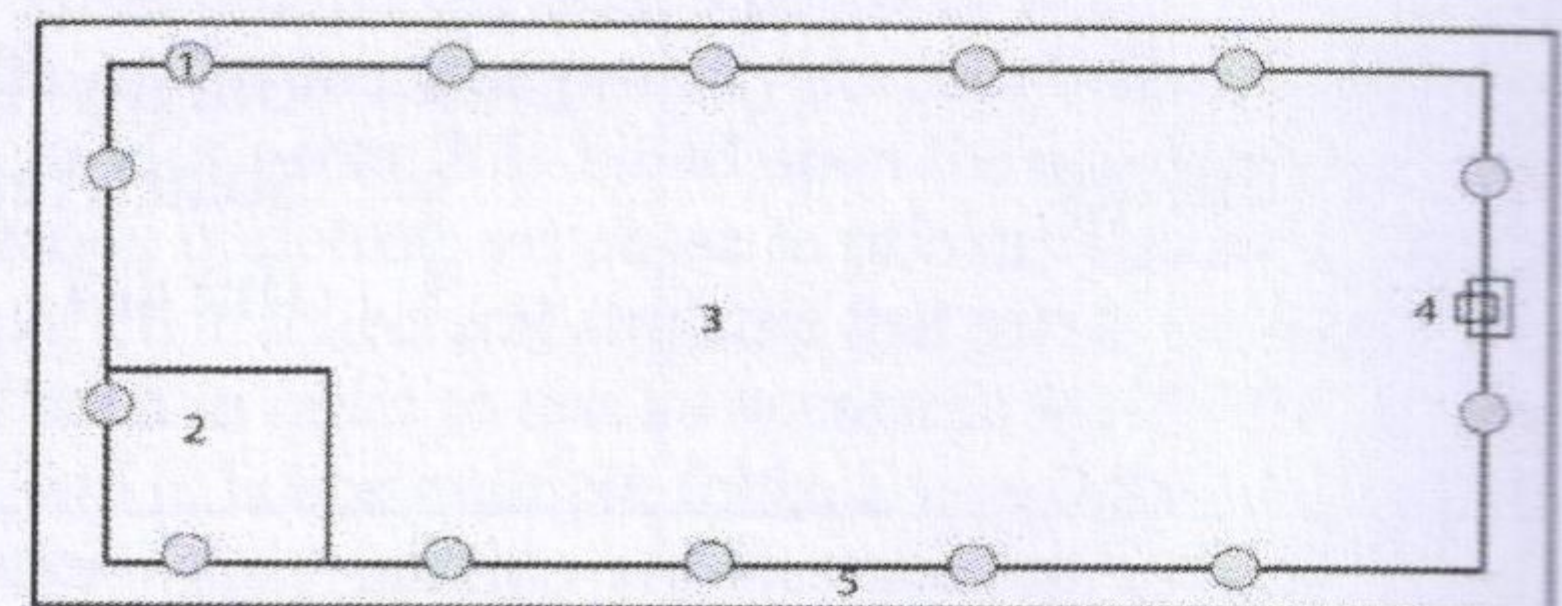

Figure 6: Fourth Floor

### Common Index-

- 1- Gravity Light
- 2- Water Tank
- 3- Vegetation/Service Area
- 4- Staircases
- 5- Pathway

### 2.6) Model Description

In table 2, we state the fundamental features of the model. According to the requirements of the farm, the apt number of floors is 4 (excluding the ground floor) with total area of 40000 sq. ft.

Building Description	
No. of floors	4
Area of each floor	10000 sq. ft.
Height between two consecutive floors	15 ft.
Height of the entire building	75ft.
Total Growth Area	26000 sq. ft.
Vegetation	
Neem	7000 sq. ft.
Bamboo	7000 sq. ft.
Senna	5000 sq. ft.
Babool*	3500 sq. ft.
Guava**	3500 sq. ft.
Assets	
Cows	30
Gravity Light***	100
Bio Gas Plant	1
Solar Trees (5 panels attached to 1 pole)	20
Personnel	10

Table 2: Model Description